



Speedster

Parts list Speedster 2020

CONTENT

For older machines, see “Parts list Speedster”.

| | |
|--|-----------|
| Ordering information | 2 |
| Parts order example..... | 3 |
| Group valve parts..... | 4 |
| Group head parts | 5 |
| Waterways | 6 |
| overview heat exchanger side | 6 |
| fill and mix..... | 6 |
| inlet block..... | 7 |
| mix block..... | 7 |
| fill block..... | 8 |
| coffee boiler fill parts and tubing | 9 |
| fill block and mix block copper tubing | 10 |
| Boiler parts on heat exchanger side | 11 |
| Boiler parts on heating side | 12 |
| Pressure gauge and double spring pre-infusion cylinder (DSPIC)..... | 13 |
| Electric control items..... | 14 |
| Steam valve and wand..... | 15 |
| Hot water valve and wand | 16 |
| Interior of steam and hot water valve | 17 |
| Brew lever (1)..... | 18 |
| Brew lever (2)..... | 19 |
| Discharge..... | 20 |
| Cup warming tray..... | 21 |
| Drip tray | 22 |
| Pump, portafilter, Idro-matic unit..... | 23 |
| Body work..... | 23 |

Explanation for tables:

| | |
|-------------------------|---|
| nip | not in picture |
| s.st. | stainless steel |
| RAW | external parts sometimes also have a raw version |
| # | first 3 digits of machine number |
| article code | Original parts have run out. Replacement parts are mostly available (see remark). |

Order parts via: spareparts@keesvanderwesten.com

See “Ordering information” and “Parts order example” on pages 2 and 3.

**When ordering parts specify the machine number the part is meant for when possible.
Refer to this parts-list revision date when ordering.**



Ordering information

When ordering spare parts directly from Kees van der Westen we ask you to send your parts list to spareparts@keesvanderwesten.com as comprehensive as possible to minimise the chance of mistakes in the delivered parts. Include the machine model, type and machine number if the parts order concerns a specific machine, also include the parts-list version you consulted.

The list should state amount, parts number and short description, see the example on the next page.

You can download the parts list on the support page that belongs to the model in question.

If the parts list is not conclusive, seek contact with support@keesvanderwesten.com before ordering.

One recipient please

When ordering parts or putting forward a question about parts, please address only one recipient on our side. When more employees receive the same email/request it is possible that all or none of the recipients feel responsible to take action.

Receive parts

In order to receive your spare parts order we need your full details, see example below:

- Billing address
- Delivery address
- Contact person
- Telephone number(s)
- E-mail address

As we do not know the final UPS shipping costs upon sending your order, we will bill you after these costs are known to us.

So you will receive the goods first and the invoice afterwards.

Payment

As for the payment of your order. Payment can be settled with PayPal or a bank wire transfer. We do not accept direct credit card transactions.

If you have a PayPal account set up it should be settled rather quickly. We could send you a payment request which takes care of it almost instantly.

A bank wire transfer is also possible, but we do not know if your bank charges additional costs and/or fees.

Please let us know which option you prefer. If you would like to pay with PayPal, we kindly ask you to inform us which email address we may send our request.



Parts order example

Send your list to: spareparts@keesvanderwesten.com

| | | |
|----------------|---------------|--------------------|
| Machine model | Speedster | parts order |
| Machine type | | |
| Machine number | 10200620 | |
| Parts list | July 13, 2021 | |

| amount | parts number | short description |
|--------|--------------|---|
| 2 | K00758-00 | anti-vacuum valve 1/4M-hose pillar; brass |
| 2 | K00782-00 | ball valve 1/4F-1/4F; nickel plated brass, butterfly handle |
| | | |
| | | |
| | | |
| | | |
| | | |
| | | |
| | | |
| | | |
| | | |
| | | |
| | | |
| | | |
| | | |
| | | |
| | | |
| | | |
| | | |
| | | |
| | | |
| | | |
| | | |
| ... | ... | |

| | |
|------------------|--|
| Customer number | (if known) |
| Contact person | Coffee Lover |
| Billing address | Espressostraat 30 1234 Arabica COLUMBIA |
| Delivery address | RistrettoLane 15-ML 1234 Arabica COLUMBIA |
| Telephone | +12 345 678 9012 |
| e-mail | c.lover@gmail.com |

Remark: **When ordering numerous parts for older machines it is wise to explain here what you like to establish. It helps us to identify possible mistakes in the parts-order such that we will seek contact to clarify the order before picking and shipping.**



Group valve parts

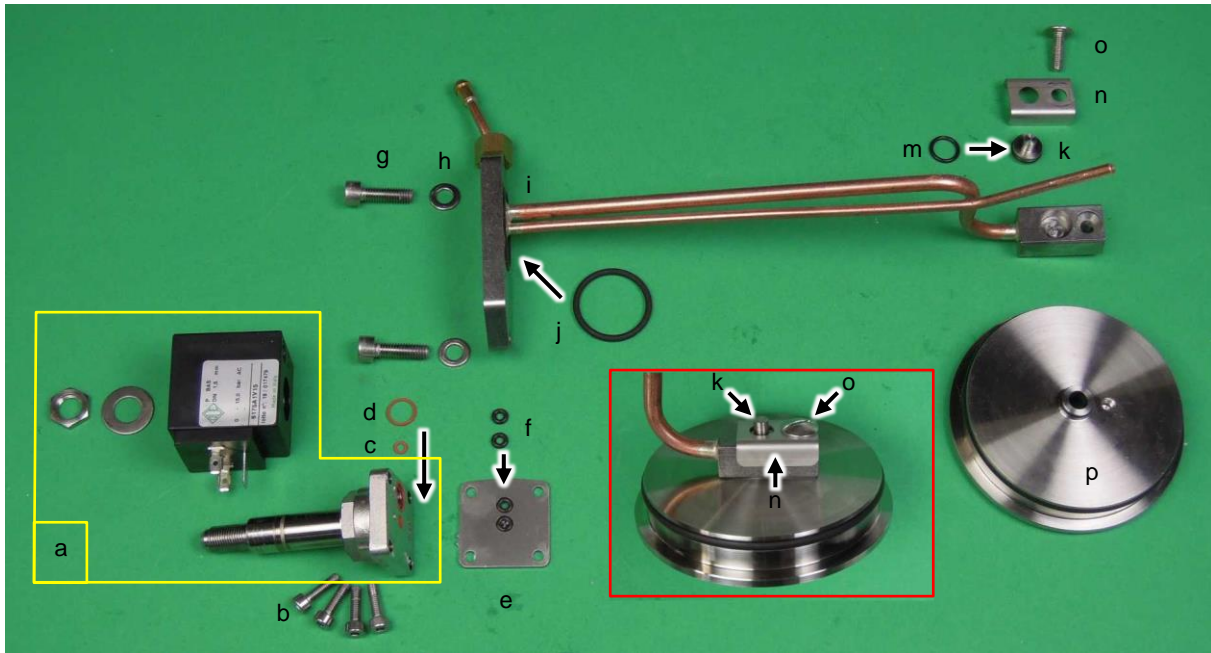

| | part number | short description | remark |
|---|-------------|--|-------------------|
| a | K02996-00 | special 3-way flange valve, orifice 1.5mm; s.st., 230V (ODE) | with O-rings |
| b | C-BZ-M4x14 | Allen bolt din912 M4x14; s.st. | |
| c | K03022-00 | O-ring Ø3x1mm, silicone (ODE 3-way valve) | centre seal (=IN) |
| d | K03023-00 | O-ring Ø9x1mm, silicone (ODE 3-way valve) | off-centre (=OUT) |
| e | K01711-00 | flat-jet CD07mm, 0.6mm; s.st. | shown w. O-rings |
| nip | K01713-00 | flat-jet CD07mm; 0.8mm; s.st. | |
| f | K01413-00 | O-ring Ø2.57x1.78mm; FKM75 (for flat-jet CD07) | |
| g | C-BZ-M6x20 | Allen bolt din912 M6x20; s.st. | |
| h | C-RS-M6 | washer din125A M6; s.st. | |
| i | K01709-03 | group valve base w. two tubes in group + 55mm line + adapter | |
| j | K01658-01 | O-ring Ø25x2.5mm; FKM75 | |
| k | K01717-00 | plug for adapter group line | |
| m | K01702-01 | O-ring Ø9.1x1.6mm; PC EPDM 75 ShA, FDA | |
| n | K01716-00 | lid for adapter group line | |
| o | C-SZ-M5x16 | slotted mushroom head screw, NF-E25-129 M5x16mm; s.st. | |
| p | | group base; O-ring seal version, s.st. | see next page |
| When an Idro-matic is placed, k + n + o will not be present; mounting the adapter to the group base is then by: | | | |
| | C-SC-M5x16 | countersunk screw din963 M5x16; s.st. | |



Group head parts



| | part number | short description | remark |
|---|-------------|--|--------|
| a | K02201-00 | group protective cap; Ivory Nylon PA6 | |
| b | K01701-01 | group protective cap; black Nylon PA6 | |
| c | C-SS-M8x16 | set screw din916 M8x16; s.st. | |
| d | C-MH-M6 | nut din934 M6; s.st. | |
| e | C-RS-M6 | washer din125A M6; s.st. | |
| f | K01689-02 | group cover, bulged top; s.st. | |
| g | K01692-00 | O-ring Ø75x2.5mm; FKM, top of group, standard size | |
| h | K01696-02 | group head rod; s.st. (with tool-grip) | |
| i | K01697-02 | group bayonet; chromed brass (without rods) | |
| j | K01695-00 | O-ring Ø71.44x3.53mm; EPDM, group base, standard size | |
| k | K01702-01 | O-ring Ø9.1x1.6mm; PC EPDM 75 ShA, FDA | |
| m | K01690-03 | group base; O-ring seal version, s.st. | |
| n | K00837-01 | O-ring Ø5.7 x 1.9mm; FKM, green or black | |
| o | K01700-03 | dispersion set; beige PEEK (base, plate, O-ring, screws) | |
| p | C-SC-M5x20 | machine screw din963 M5x20; s.st. | |
| q | K00826-00 | group ring; 8.0mm (Arinca) | |
| r | K00824-00 | group shower screen; s.st., KvdW logo | |



Waterways

overview heat exchanger side

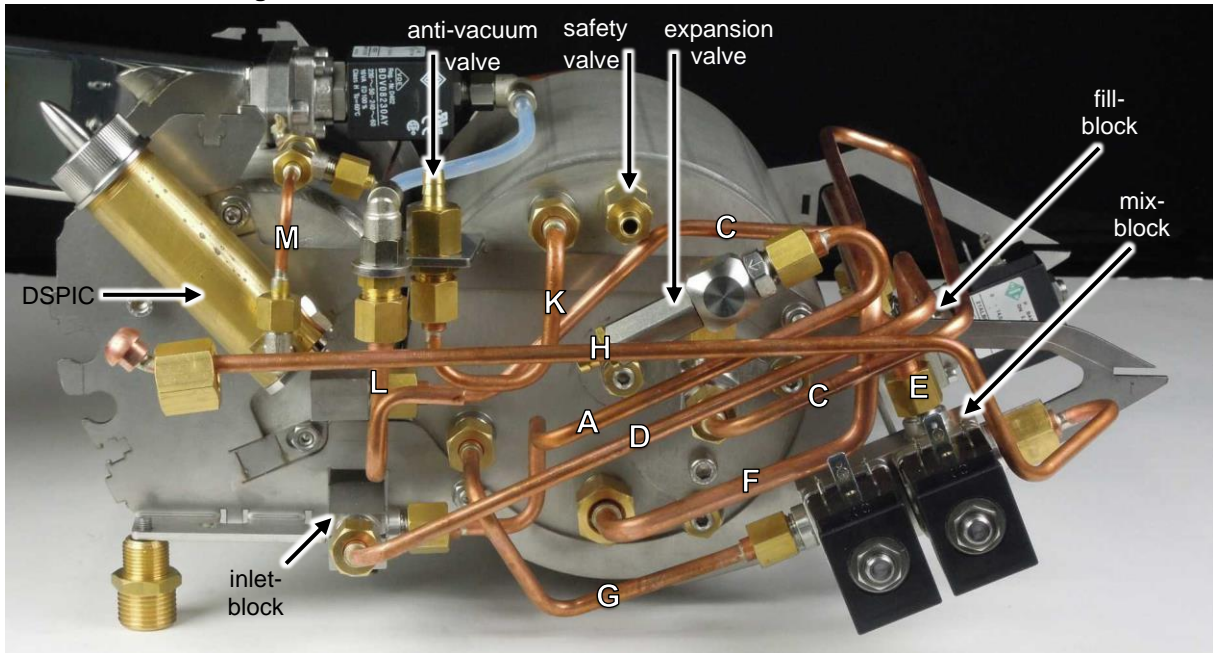

All copper lines are marked with individual **OUTLINED CAPITALS** throughout this parts list.

fill and mix

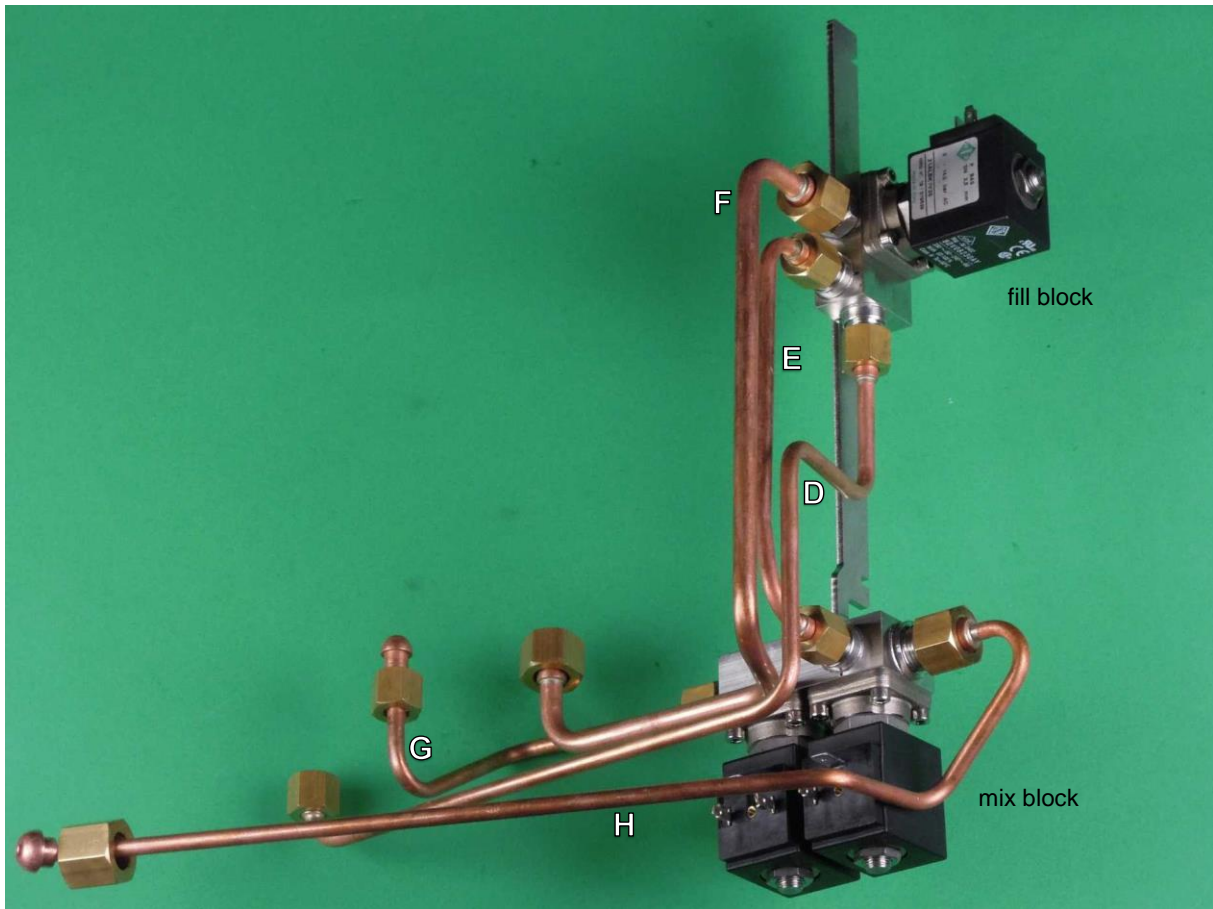

inlet block



| | part number | short description | remark |
|---|-------------|--|--------|
| a | K03101-00 | inlet block, Speedster 2020, bare; s.st. | |
| b | K03061-00 | pushfit coupling, straight 1/4"-8mm, s.st., FKM O-ring | |

mix block

K03108-00

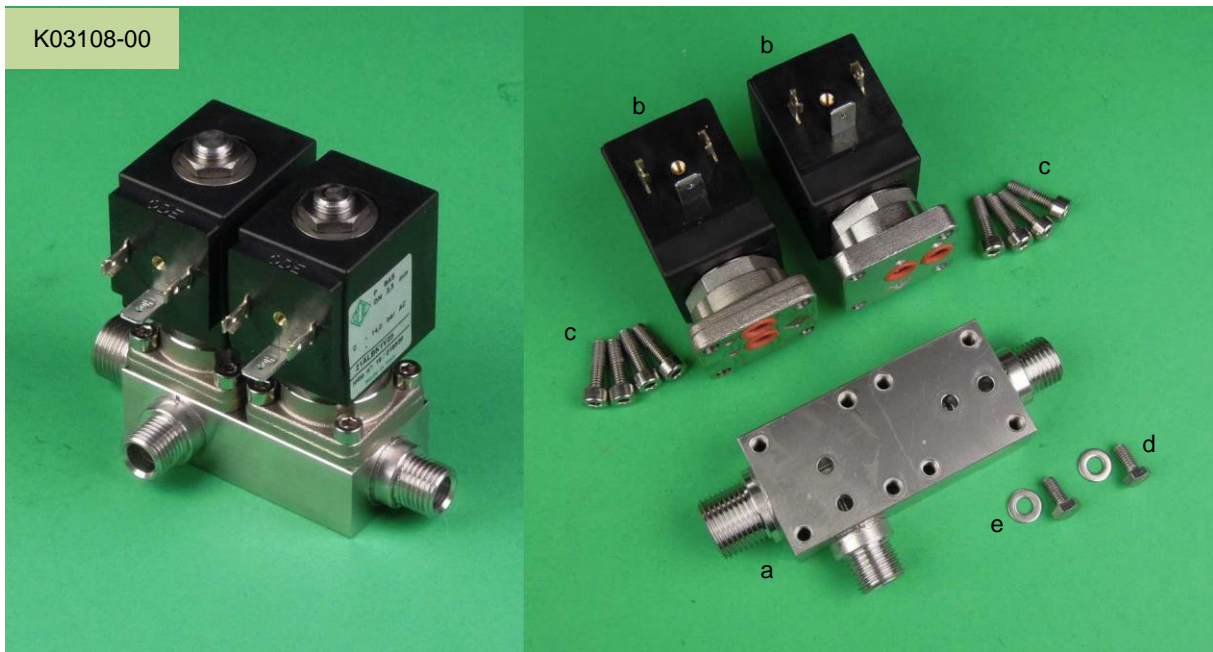

| | part number | short description | remark |
|---|-------------|---|--------|
| | K03108-00 | assembly: mix block Speedster 2020 | |
| a | K03107-00 | mix block, Speedster 2020, bare; s.st. | |
| b | K02452-00 | 2-way flange valve, orifice 2.5mm; s.st.; coil 230V (ODE) | |
| c | C-BZ-M4x14 | Allen bolt din912 M4x14mm; s.st. | |
| d | C-BT-M4x08 | bolt din933 M4x8; s.st. | |
| e | C-RS-M4 | washer din125A M4; s.st. | |



fill block

K03105-00

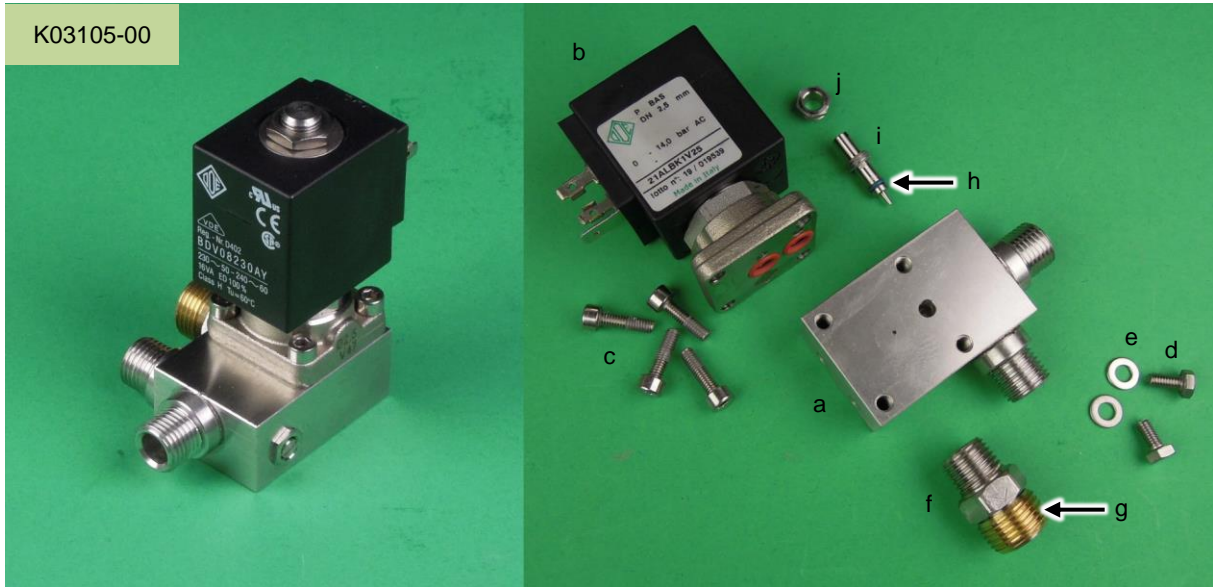

| | part number | short description | remark |
|---|-------------|---|---------------------|
| | K03105-00 | assembly: fill block, Speedster 2020 | |
| a | K03104-00 | fill block, bare, Speedster 2020; s.st. | |
| b | K02452-00 | 2-way flange valve, orifice 2.5mm; s.st., coil 230V (ODE) | |
| c | C-BZ-M4x14 | Allen bolt din912 M4x14mm; s.st. | |
| d | C-BT-M4x08 | bolt din933 M4x8; s.st. | |
| e | C-RS-M4 | washer din125A M4; s.st. | |
| f | K02235-00 | 1-way valve 1/4M-1/4M; s.st. | |
| g | K02447-00 | thread adaptor; G3/8" - G1/4"; brass | |
| h | K02369-00 | O-ring Ø3.5x1.0 mm; FKM 80ShA, blue, FDA | |
| i | K02145-00 | jet needle; s.st., Ø5x26mm with thread M8x0.75mm | cold water addition |
| j | K02146-00 | locking nut for jet needle; s.st., ~Ø9x5mm; M8x0.75mm | |



coffee boiler fill parts and tubing

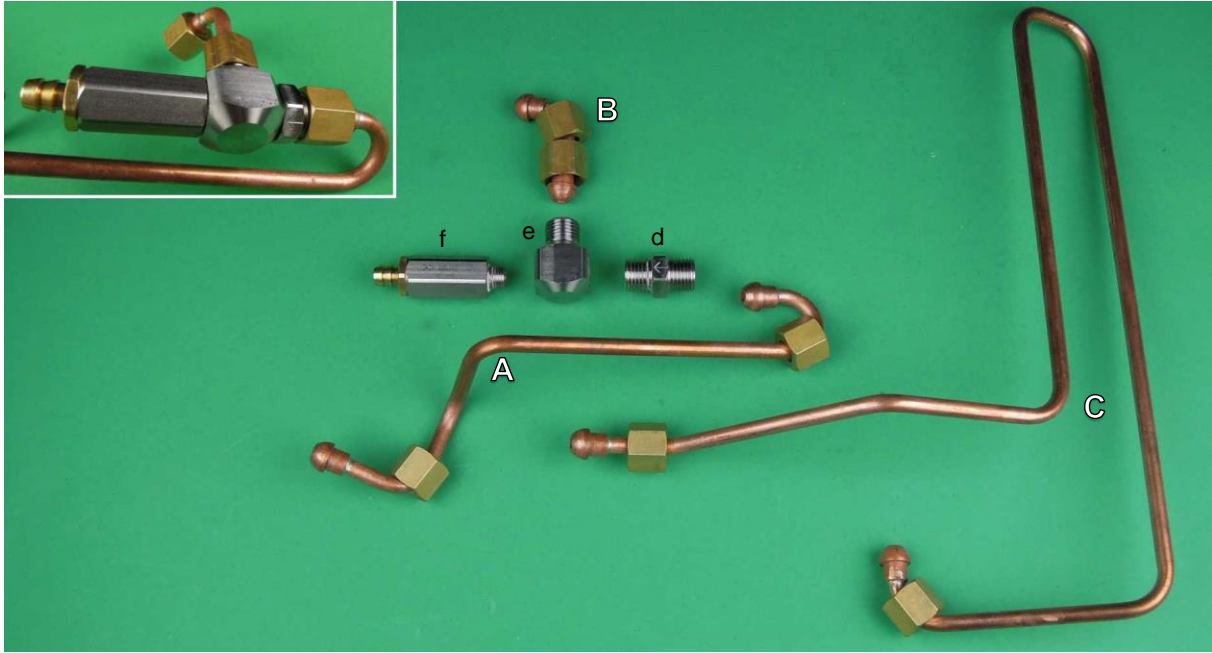

| | part number | short description | remark |
|---|-------------|--|----------------|
| A | K02765-00 | 6mm line, inlet block ↔ expansion; copper | |
| B | K02760-00 | 6mm line, expansion banjo ↔ HX banjo; copper | |
| C | K02764-00 | 6mm line, HX banjo ↔ coffee boiler; copper | |
| d | K02235-00 | 1-way valve, 1/4M-1/4M; s.st. | |
| e | K02790-00 | T-fitting, 1/4Mx1/8Fx12mmF; s.st. | |
| f | K02267-00 | expansion valve 12bar, 1/8M-8.4mm; s.st. | not adjustable |



fill block and mix block copper tubing

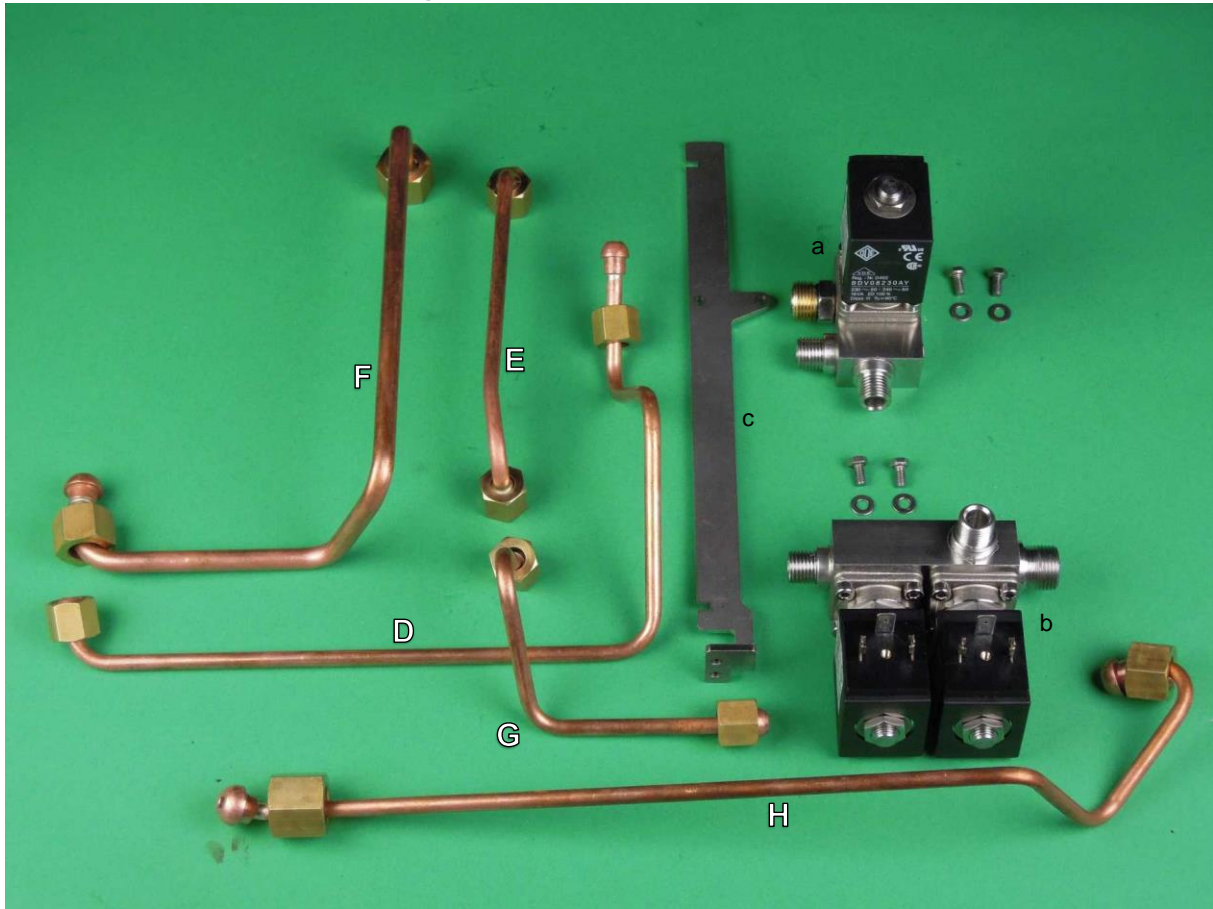



| | part number | short description | remark |
|---|-------------|--|--------|
| a | K03105-00 | assembly: fill block Speedster 2020 | |
| b | K03108-00 | assembly: mix block Speedster 2020 | |
| c | K03077-00 | fill block and mix block bracket Speedster 2020; s.st. | |
| D | K02757-00 | 6mm line, inlet block ↔ fill block; copper | |
| E | K02759-00 | 6mm line, fill block ↔ mix block; copper | |
| F | K02756-00 | 8mm line, fill block ↔ steam boiler; copper | |
| G | K02762-00 | 6mm line, steam boiler ↔ mix block; copper | |
| H | K02761-00 | 6mm line, mix block ↔ hot water valve; copper | |

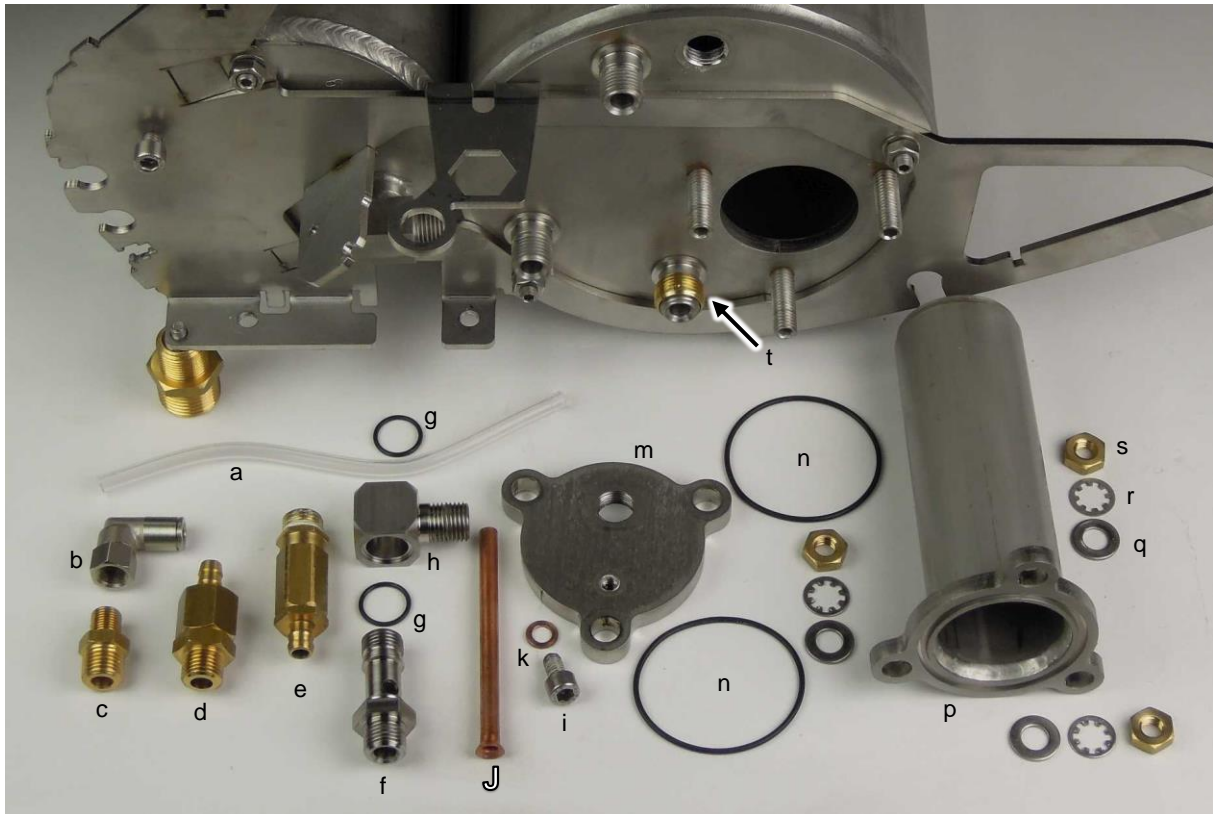

Boiler parts on heat exchanger side



| | part number | short description | remark |
|---|-------------|--|--|
| a | K02288-00 | pushfit hose, polyphthalamide, 2 x 4mm, transparent | 150 mm long |
| b | K02281-00 | pushfit coupling, elbow 1/8M - 6mm | |
| c | K00864-00 | fitting 1/8M-1/4M; brass | connects to tube  |
| d | K00758-00 | anti-vacuum valve 1/4M-hose pillar; brass | |
| e | K01535-00 | pressure safety valve 1/4M-hose pillar; 3.0 bar, brass | |
| f | K02779-00 | banjo bolt 1/4"; s.st. | |
| g | K02788-00 | O-ring Ø13.5x1.5mm; CS FKM (Viton) 75 ShA FDA | |
| h | K02780-00 | banjo fitting, 1/4"; s.st. | |
| i | C-BZ-M6x06 | Allen bolt din912 M6x6mm; s.st. | drain bolt |
|  | K01541-02 | 6mm line, flared HX injection (80mm long); copper | inserts in f |
| k | K00823-00 | ring M6; copper | |
| m | K03099-00 | heat exchanger flange, Speedster 2020; s.st. | |
| n | K03021-00 | O-ring Ø47.35x1.78mm; EPDM, FDA (HX Speedster) | |
| p | K01559-01 | heat exchanger Speedster, main body; s.st. | |
| q | C-RS-M8 | washer din125A M8; s.st. | |
| r | C-RT-M8 | lock washer din6798A M8; s.st. | |
| s | K01703-00 | nut M8, 5mm thick; brass | |
| t | K02447-00 | thread adaptor; G3/8" - G1/4"; brass | on fill fitting |



Boiler parts on heating side

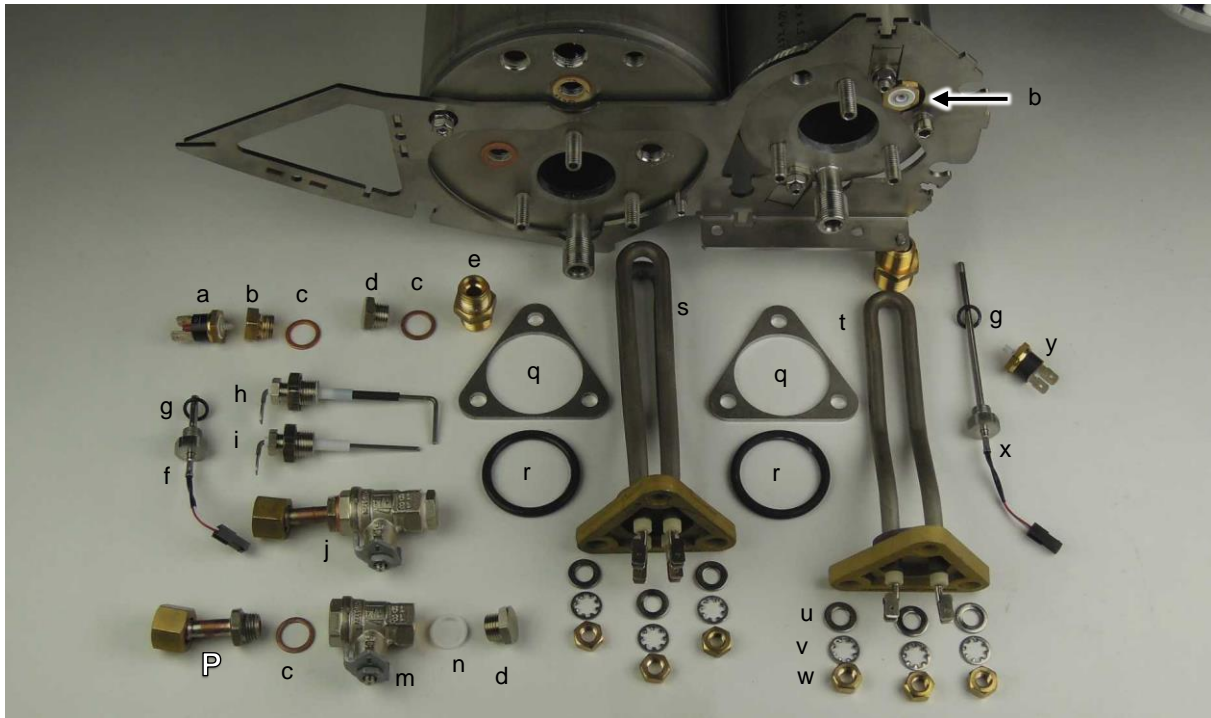

| | part number | short description | remark |
|-----|-------------|--|---------------------|
| a | K01597-00 | overheat safety switch 145°C M4; manual re-set | |
| nip | | overheat cut-out 135°C, M4; manual re-set (Thermorex TK32) | |
| b | K01704-00 | plug 1/4M-M4F; brass | |
| c | K00785-00 | ring 1/4"; copper | |
| d | K00781-00 | plug 1/4"; nickel plated brass | |
| e | K00719-00 | fitting 3/8M-3/8M; brass | |
| f | K03006-00 | Temperature sensor, Pt100, 27mm; s.st. with molex | comes with O-ring |
| g | K02286-00 | O-ring; Ø9.25x1.78 mm; Viton green | can also be black |
| h | K01601-00 | level probe 125mm; s.st., bent faston, bent end, with rubber | |
| i | K00802-00 | level probe 125mm(?); s.st., bent faston | |
| j | | drain valve assembly | k+c+m+n+d |
| m | K02284-00 | ball valve 1/4F-1/4F; nickel plated brass, custom handle | |
| n | K00694-00 | ring 1/4"; Teflon (17x13x2mm) | |
| P | K01035-00 | 8mm line, manifold ↔ combi-valve (long) (?); copper | |
| q | K01676-00 | triangular O-ring spacer for s.st. boiler, 3mm thick; s.st. | |
| r | K01656-02 | O-ring Ø39x4.5mm; FKM (gasket for heating element) | |
| s | K01599-03 | heating element 2x900W; 230Vac, faston (Backer) | |
| t | K01669-03 | heating element 1x900W; 230Vac, faston (Backer) | |
| u | C-RS-M8 | washer din125A M8; s.st. | |
| v | C-RT-M8 | lock washer din6798A M8; s.st. | |
| w | K01703-00 | nut M8, 5mm thick; brass | |
| x | K03005-00 | Temperature sensor, Pt100, 100mm; s.st. with molex | comes with O-ring |
| y | K01668-00 | overheat safety switch 107°C M4; automatic re-set | note plug on boiler |
| nip | | overheat cut-out 100°C, M4; manual re-set (Thermorex TK32) | |



Pressure gauge and double spring pre-infusion cylinder (DSPIC)

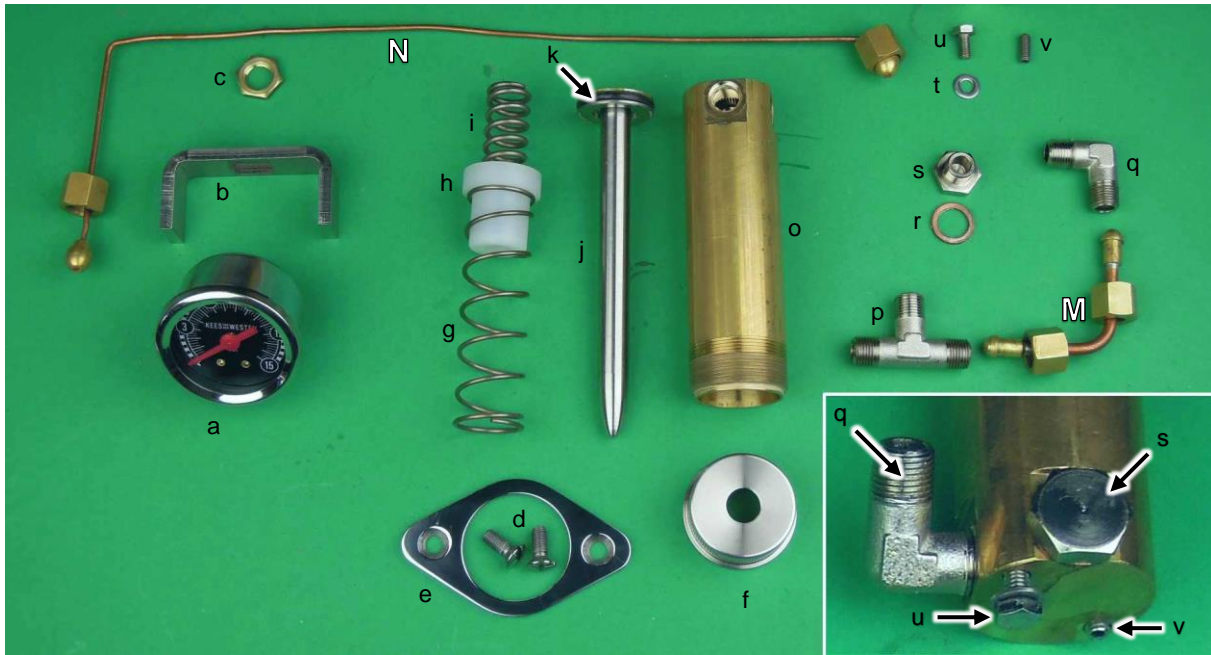

| | part number | short description | remark |
|---|-------------|--|--------|
| a | K00790-00 | pressure gauge 15 bar; KvdW marking | |
| b | K02289-00 | bracket for pressure gauge; s.st. | |
| c | K00820-00 | flat nut 1/8"; brass | |
| d | K00234-00 | metal screw din964 M5x12; s.st., polished head | |
| e | K03097-00 | front mounting plate DSPIC; polished s.st. | |
| f | K02210-00 | top cap for DSPIC; s.st. | |
| g | K02220-00 | spring 1.6x20x73.5; CSS - 79N; DSPIC (upper spring) | |
| h | K02213-00 | spring-spacer of DSPIC; white nylon | |
| i | K02221-00 | spring 2x12.5x49.5; CSS - 236N; DSPIC (lower spring) | |
| j | K02214-00 | piston for DSPIC; s.st. | |
| k | K00616-01 | O-ring Ø20.3x2.62mm; FKM75 (PPIC & DSPIC) | |
| M | K02766-00 | 4mm line, T fitting ↔ DSPIC; copper | |
| N | K02755-00 | 2mm line, T fitting ↔ pressure gauge; copper | |
| o | K02212-00 | cylinder for DSPIC; brass | |
| p | K01655-00 | T-fitting 1/8Mx1/8Mx1/8M; nickel plated brass | |
| q | K00863-00 | elbow fitting 1/8M-1/8M; nickel plated brass | |
| r | K00786-00 | ring 1/8"; copper | |
| s | K00635-00 | plug 1/8M; nickel plated brass | |
| t | C-RS-M4 | washer din125A M4; s.st. | |
| u | C-BT-M4x08 | bolt din993 M4x8mm; s.st. | |
| v | C-SS-M4x10 | set screw din916 M4x10; s.st. | |



Electric control items

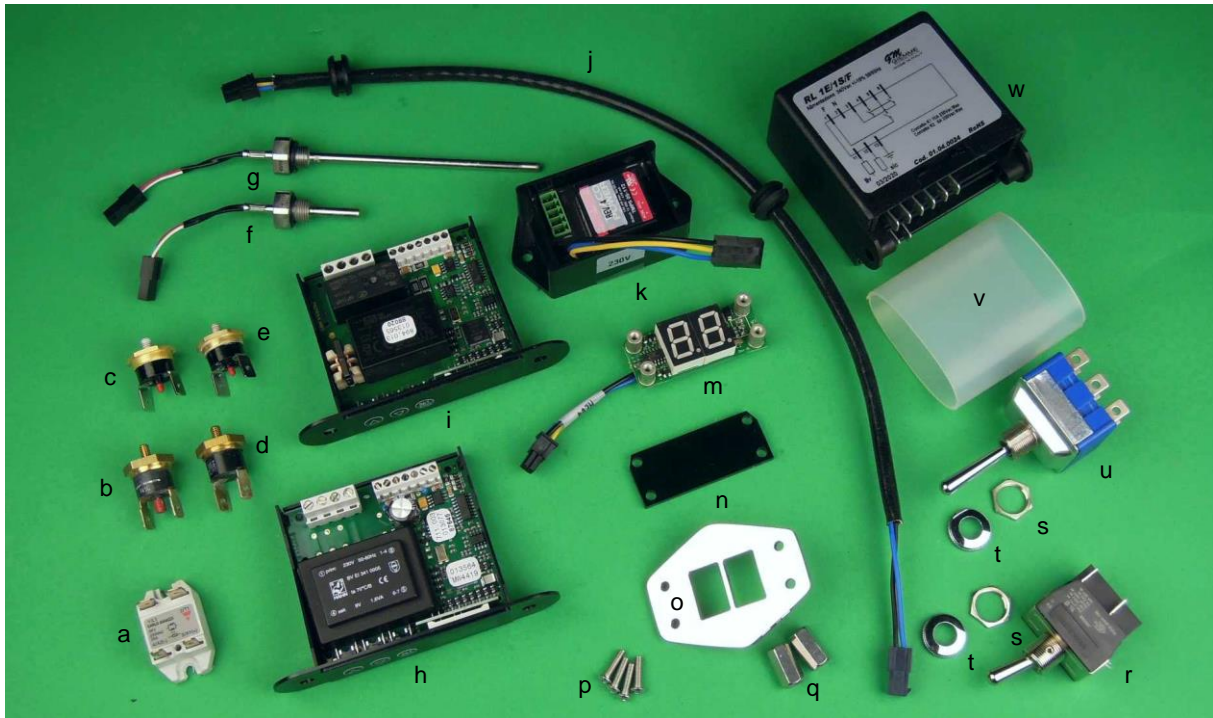

| | part number | short description | remark |
|---|-------------|--|---------------------|
| a | K00815-00 | solid state relay, NO, control 9-18Vdc, 25A /230Vac, miniature | |
| b | K01597-00 | temperature cut-out 145°C, M4; manual re-set | will be replaced |
| c | K01597-01 | temperature cut-out 135°C, M4; manual re-set | steam boiler |
| d | K01668-00 | temperature limiter 107°C, M4; automatic re-set | will be replaced |
| e | K01668-01 | temperature cut-out 100°C, M4; manual re-set | coffee boiler |
| f | K03006-00 | temperature sensor, Pt100, 27mm; s.st. with Molex | steam boiler |
| g | K03005-00 | temperature sensor, Pt100, 100mm; s.st. with Molex | coffee boiler |
| h | K00809-00 | temperature controller 220-240Vac; Störk ST25 ECO | specify: 50/60Hz, |
| i | K00809-01 | temperature controller 100-240Vac; Störk ST25 ECO | steam/coffee; °C/°F |
| j | K03054-01 | shot timer converter-cable; 6- (F) to 4- (M) pole Molex | |
| k | K03053-01 | shot timer combi-PCB 220-240Vac; 6-pole (M) Molex plug | |
| m | K01681-00 | shot timer display with 4-pole (F) Molex plug | |
| n | K01682-00 | shot timer window; 3mm thick grey plastic | |
| o | K01588-00 | shot timer front plate with digit separator; s.st. polished | |
| p | K00019-00 | Allen screw iso7380 M3x10; s.st. | |
| q | K00161-00 | connection nut din6334 M5 (H=3D); s.st. | |
| r | VK01606-00 | toggle switch, DPST, OFF-ON, 16A/250V | will be replaced |
| | K01606-01 | toggle switch, DPST, OFF-ON, 16A/250V | |
| s | K00896-00 | flat mounting nut for switches | comes with j & k |
| t | K00805-00 | chrome plated nut for switches | |
| u | K01600-00 | toggle switch, 3PDT, (ON)-OFF-(ON), 10A/250V | includes s+t |
| v | K03063-00 | silicone sleeve, Ø40x1,5x60 mm | insulator for u |
| w | K00697-01 | electronic level controller 240V; (Giemme), incl. housing | |



Steam valve and wand



Note that base of steam valve body is pointing in other direction than on hot water valve body.

| | part number | short description | remark |
|---|-------------|--|-------------------|
| a | K00685-01 | steam valve; chromed brass, with lock washer and nut | RAW: K00869-00 |
| b | K00180-00 | lock washer din6797J M16; s.st. | |
| c | K00284-00 | flat nut 3/8; brass (not chrome plated!) | alternative for c |
| d | K02733-00 | washer Ø13mm, inner square 6.6mm; s.st. | |
| e | K02728-00 | steam valve knob; black Nylon, custom (tulip model) | |
| f | K02119-00 | steam valve knob; cream Nylon, custom (tulip model) | |
| g | K00173-00 | fender washer din9021 M6; s.st. | |
| h | K00165-00 | lock nut din986 M6; s.st., dome cap | |
| i | K00849-00 | spring; s.st. (against trumpet plunger, appr. 1.5x8x30mm) | |
| j | K00851-00 | trumpet plunger; brass, complete with two O-rings | |
| k | K00850-00 | O-ring Ø7.2x1.9 mm; EPDM, on brass trumpet plunger | 2 are needed |
| m | K00852-00 | O-ring (appr. Ø10.5x2.7mm); red silicone | |
| n | K00855-00 | ring 3/8"; Teflon (21x16.8x2 mm) | |
| o | K00853-00 | ball-joint nut 22mm; chromed bronze | RAW: K00854-00 |
| p | K01753-00 | steam wand Speedster; polished s.st. | RAW: K02203-00 |
| Q | K01537-00 | 8mm line, steam boiler ↔ steam valve; copper | |
| r | K02360-00 | anti-burn sleeve on steam wand; 110mm | |
| s | K01751-00 | steam wand tip 4x1.2mm; s.st. | RAW: K01752-00 |
| | K00868-00 | service kit steam/hot water wand (2x K00850 + K00852 + K00855) | k (2x) + m + n |



Hot water valve and wand

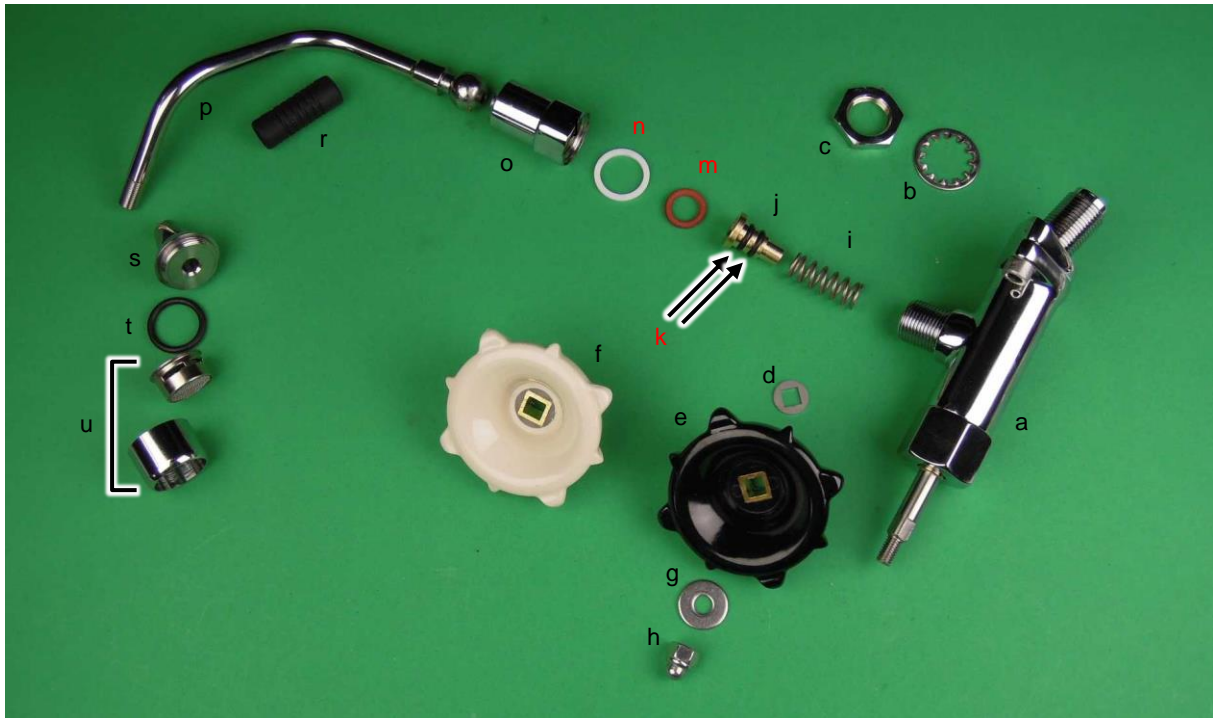

Note that base of hot water valve body is pointing in other direction than on steam valve body.

| | part number | short description | remark |
|---|-------------|--|-------------------|
| a | K01750-00 | hot water valve; chromed brass, with lock washer and nut | modified K00685 |
| b | K00180-00 | lock washer din6797J M16; s.st. | |
| c | K00284-00 | flat nut 3/8; brass (not chrome plated!) | alternative for c |
| d | K02733-00 | washer Ø13mm, inner square 6.6mm; s.st. | |
| e | K02728-00 | steam valve knob; black Nylon, custom (tulip model) | |
| f | K02119-00 | steam valve knob; Ivory coloured Nylon, custom (tulip model) | |
| g | K00173-00 | fender washer din9021 M6; s.st. | |
| h | K00165-00 | lock nut din986 M6; s.st., dome cap | |
| i | K00849-00 | spring; s.st. (against trumpet plunger, appr. 1.5x8x30mm) | |
| j | K00851-00 | trumpet plunger; brass, complete with two O-rings | |
| k | K00850-00 | O-ring Ø7.2x1.9 mm; EPDM, on brass trumpet plunger | 2 are needed |
| m | K00852-00 | O-ring (appr. Ø10.5x2.7mm); red silicone | |
| n | K00855-00 | ring 3/8"; Teflon (21x16.8x2 mm) | |
| o | K00853-00 | ball-joint nut 22mm; chromed bronze | RAW: K00854-00 |
| p | K01754-00 | hot water wand Speedster; polished s.st. | |
| r | K00862-00 | anti-burn sleeve on steam/water wand | |
| s | K00856-00 | hot water wand tip; s.st. (mushroom shape) | |
| t | K00858-00 | O-ring (appr. Ø16.5x2.7mm); EPDM (hot water screen assy) | |
| u | K00857-00 | screen assembly on hot water wand tip; chrome plated brass | RAW: K00859-00 |
| | K00868-00 | service kit steam/hot water wand (2x K00850 + K00852 + K00855) | k (x2) + m + n |



Interior of steam and hot water valve

Metal ball and small spring -marked **R**- are removed in both valves.
Parts marked **S** are present in steam valve only.



Not all parts are sold separately.

| | part number | short description | remark |
|----------|-------------|--|-----------------------|
| a | K00860-00 | ring 24x18x2mm; Teflon (between steam valve body and base) | |
| b | K00821-00 | spring; s.st. (appr. 2x9x31mm) | at steam plunger |
| c | K00873-00 | plunger in steam valve; brass, with Viton sealing disk | |
| d | K00871-00 | sealing disk 13x4x4 mm; Viton (on steam valve plunger) | |
| e | | Allen bolt din912 M6x14; s.st | |
| f | C-BZ-M6x20 | Allen bolt din912 M6x20; s.st. | |
| g | K00861-00 | ring 15.5x7.5x5x4mm (seal on steam valve shaft) | 2 are needed |
| h | K00822-00 | spring; s.st. (appr. 2x12x17mm) | in end-cap |
| | K00874-00 | service kit steam valve (K00860 + K00871 + 2x K00861) | a + d + g (2x) |



Brew lever (1)

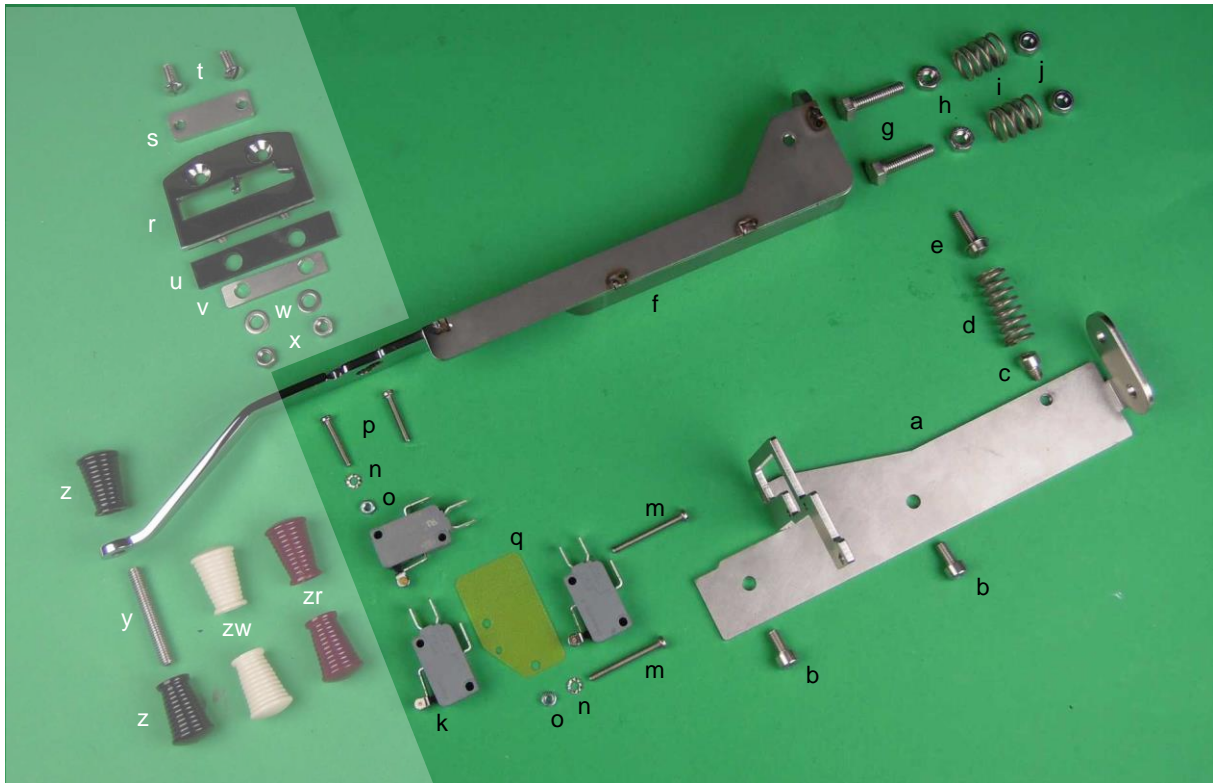

| | part number | short description | remark |
|---|-------------|---|--------|
| a | K03093-00 | brew lever mounting bracket Speedster 2020; s.st. | |
| b | C-BZ-M5x10 | Allen bolt din912 M5x10; s.st. | |
| c | C-BZ-M5x06 | Allen bolt din912 M5x6; s.st. | |
| d | K00821-00 | spring; s.st. (appr. 2x9x31mm) | |
| e | K01635-00 | adjusting screw M5 for spring; s.st., length 20mm | |
| f | K03095-00 | brew lever Speedster 2020; s.st., partly polished | |
| g | C-BT-M6x25 | bolt din933 M6x25; s.st. | |
| h | C-MH-M6 | nut din934 M6; s.st. | |
| i | K00822-00 | spring; s.st. (appr. 2x12x17mm) | |
| j | C-MB-M6 | lock nut din985 M6; s.st. | |
| k | K03050-00 | micro-switch, SPDT, roller lever; 16A/250V | |
| m | C-SG-M3x30 | machine screw din84 M3x30; s.st. | |
| n | C-RT-M3 | lock washer din6798A M3; s.st. | |
| o | C-MH-M3 | nut din934 M6; s.st. | |
| p | C-SG-M3x20 | machine screw din84 M3x20; s.st. | |
| q | K03051-00 | micro-switch isolation plate | |

for parts with white letters, see next page



Brew lever (2)

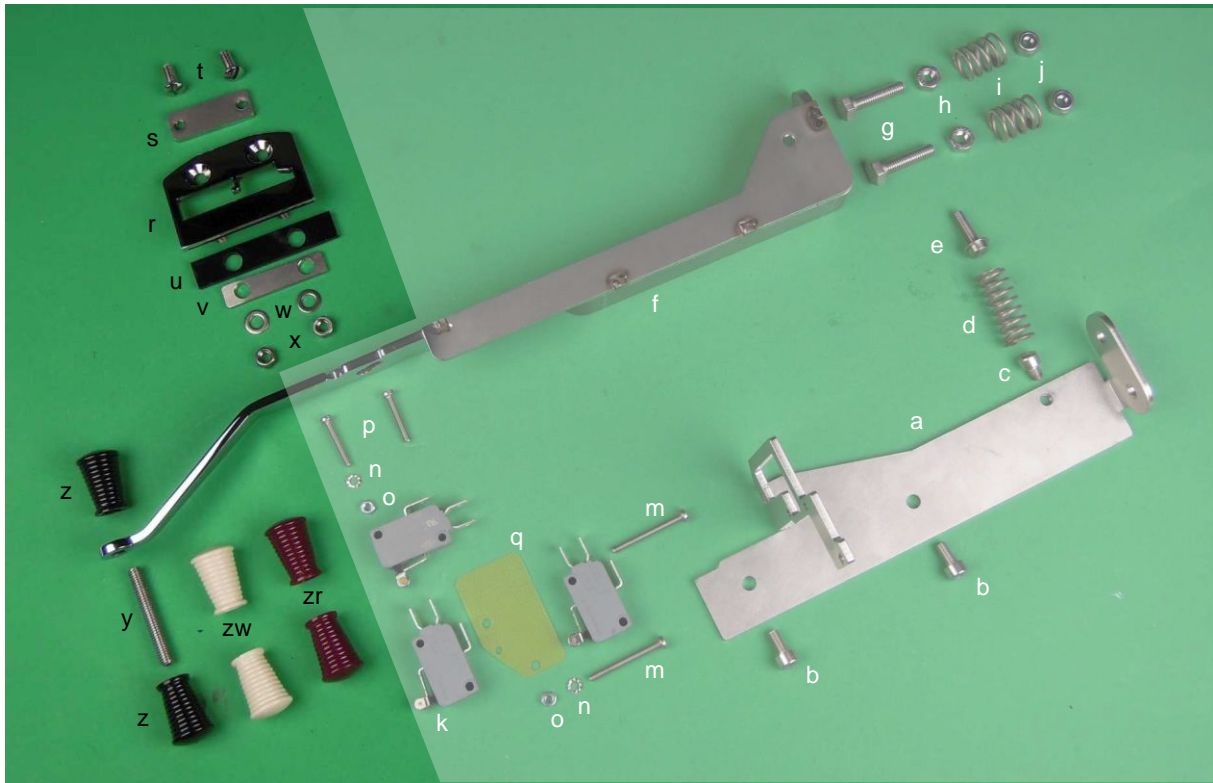

| | part number | short description | remark |
|---|-------------|---|--------|
| for parts with white letters, see previous page | | | |
| r | K03096-00 | brew lever guide plate Speedster 2020; polished s.st. | |
| s | K03094-00 | fixing plate brew lever guide, with M5 threads, s.st. | |
| t | K00234-00 | metal screw din964 M5x12; s.st., polished head | |
| u | K03109-00 | brew lever guide; 58x13x3mm, black POM | |
| v | K03064-00 | fixing plate POM brew lever guide; 44x10mm, s.st. | |
| w | C-RS-M5 | washer din125A M5; s.st. | |
| x | C-MH-M5 | nut din934 M5; s.st. | |
| y | C-SS-M6x40 | set screw din916 M6x40; s.st. | |
| z | K02389-00 | lever knob, ribbed, M6F; black Nylon PA6 | |
| zw | K02390-00 | lever knob, ribbed, M6F; Ivory Nylon PA6 | |
| zr | K02388-00 | lever knob, ribbed, M6F; red Nylon PA6 | |



Discharge

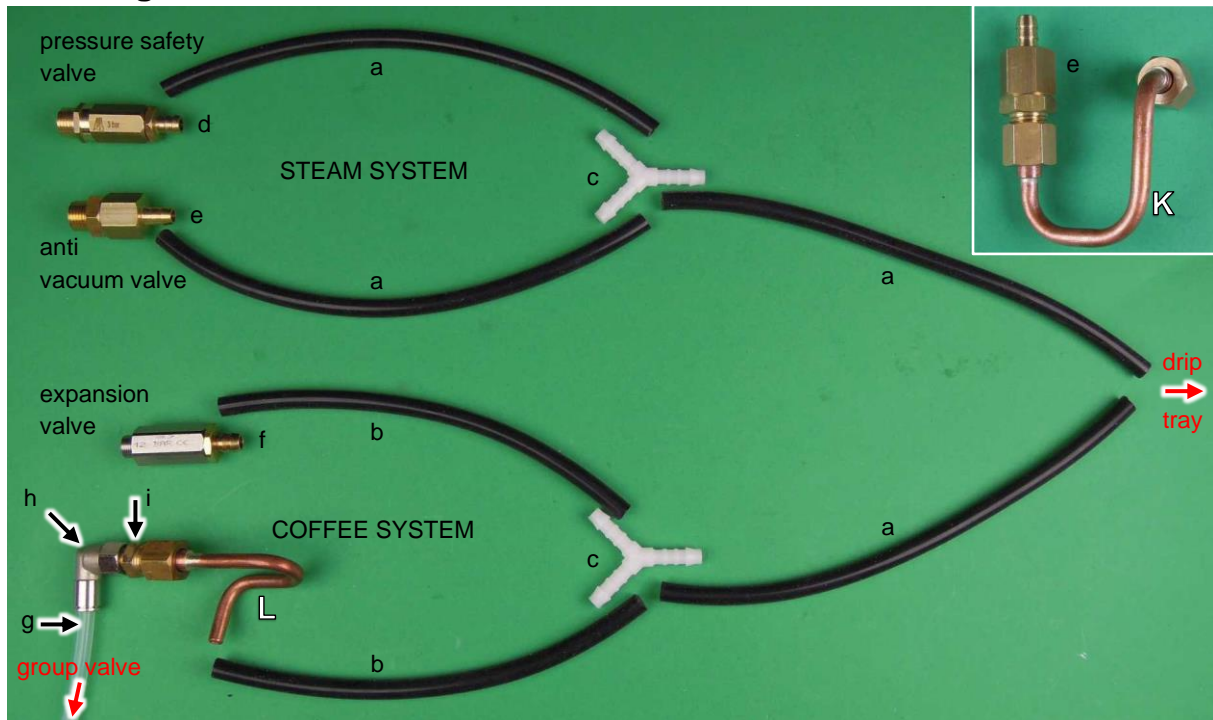

| | part number | short description | remark |
|-------------------------------|-------------|--|---------------------|
| a | C-HS-ZZ4x8 | hose 4x8mm; black silicone, per meter | 220 mm |
| b | C-HS-ZZ4x8 | hose 4x8mm; black silicone, per meter | 180 mm |
| c | K01554-00 | Y-shape hose connector 6mm; white POM | |
| d | K01535-00 | pressure safety valve 1/4M-hose pillar; 3.0 bar, brass | |
| K | K02763-00 | 6mm line; steam boiler ↔ anti vacuum valve; copper | |
| e | K00758-00 | anti-vacuum valve 1/4M-hose pillar; brass | |
| f | K02267-00 | expansion valve 12bar, 1/8M-8.4mm; s.st. | |
| discharge of the group-valve: | | | |
| nip | K02236-00 | O-ring Ø6.8 x1.2mm; FKM 75ShA, FDA | in pushfit on valve |
| | K02281-00 | pushfit coupling, elbow 1/8M - 6mm | |
| g | K02288-00 | pushfit hose, polyphthalamide, 2 x 4mm, transparent | 150 mm long |
| h | K02279-00 | pushfit coupling, elbow 1/4M - 6mm | |
| i | K00864-00 | fitting 1/8M-1/4M; brass | |
| L | K02758-00 | 6mm line: group valve elbow ↔ drain hose; copper | |



Cup warming tray

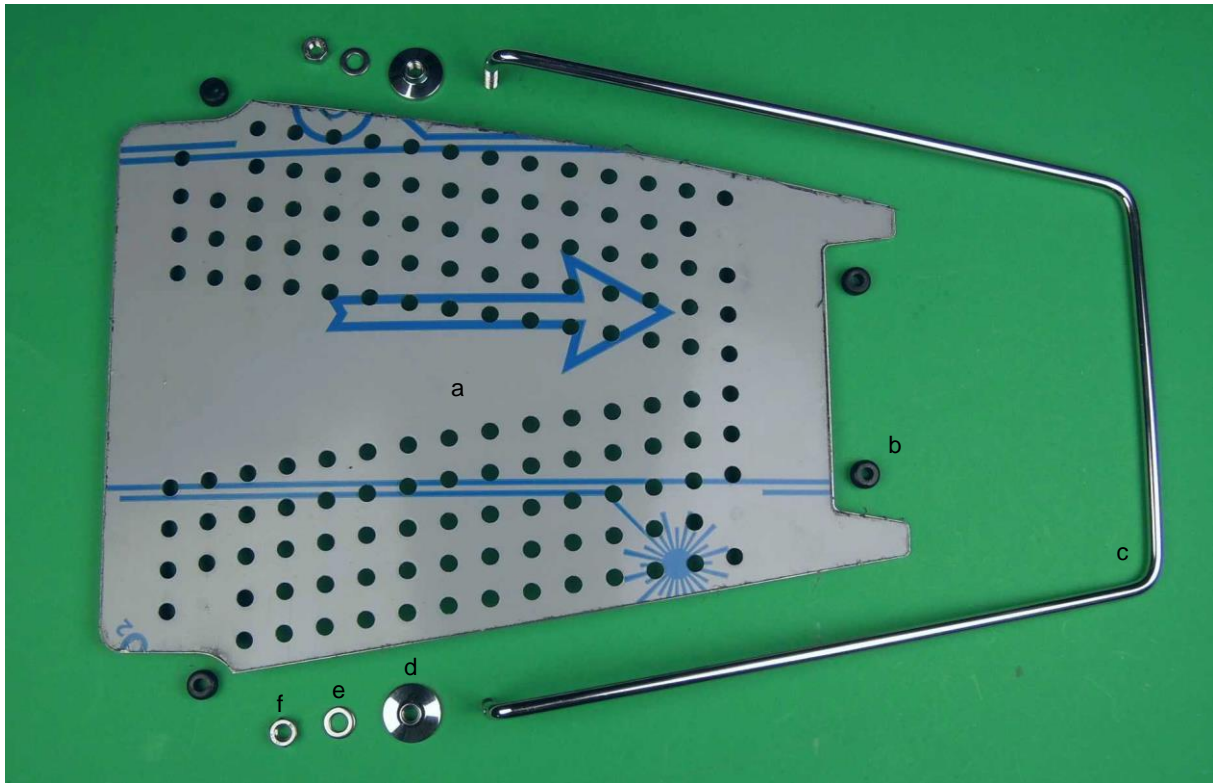

| | part number | short description | remark |
|---|---------------|---|-------------|
| a | K03089-00 | cup warming tray Speedster 2020; brushed finish s.st. | * see below |
| b | C-DT-5x11x1,5 | grommet A=5, D=1.5; black PVC | |
| c | K01625-00 | rail for cup warming tray; polished s.st., standard | |
| d | K01622-00 | support collar M6; polished s.st. | |
| e | C-RS-M6 | washer din125A M6; s.st. | |
| f | C-MH-M6 | nut din934 M6; s.st. | |

* The cup warming tray is shown on the photo with the protective foil not removed yet.



Drip tray

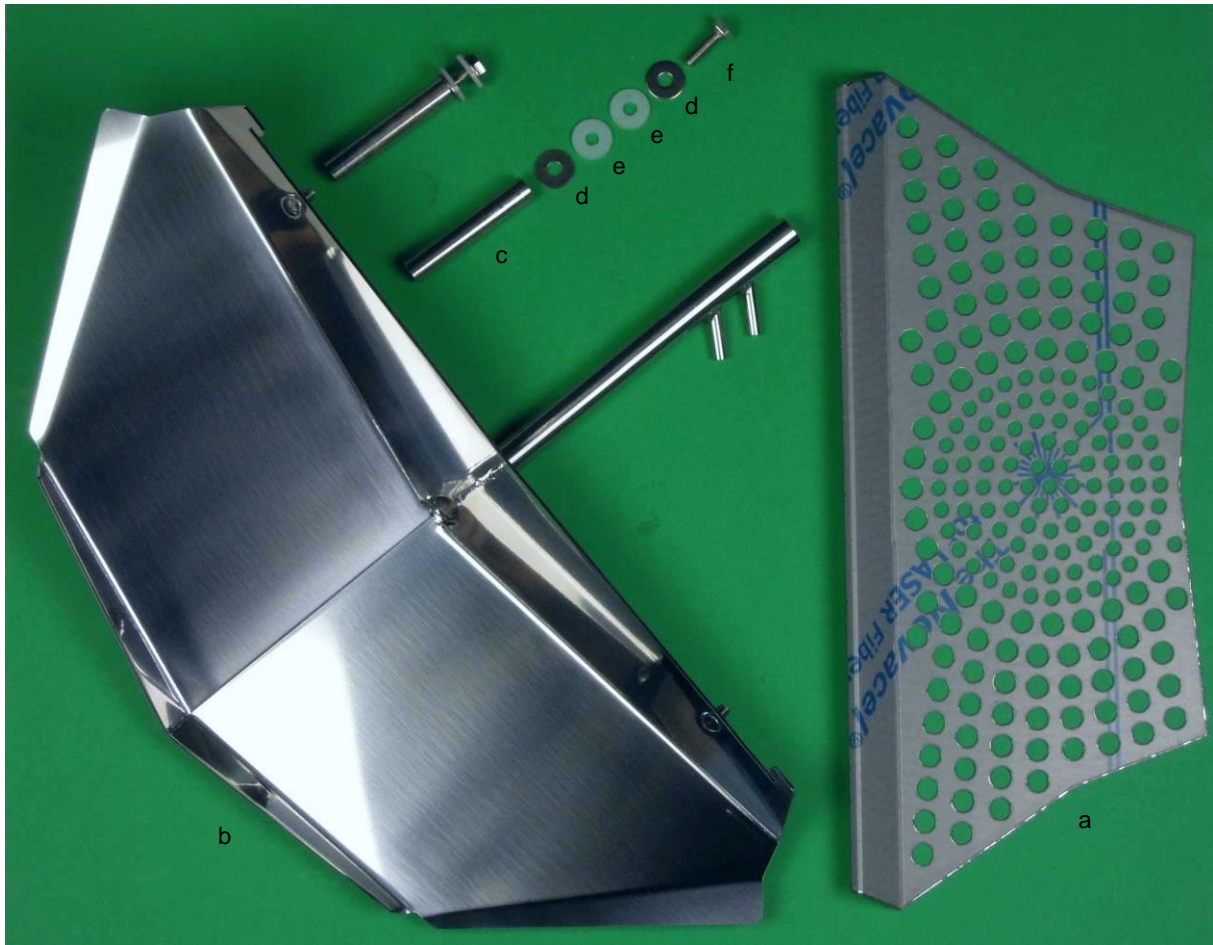

| | part number | short description | remark |
|---|-------------|--|----------------|
| a | K01619-01 | drip tray grill Speedster; s.st., with small cut-outs on sides | * see below |
| b | K01618-00 | drip tray Speedster; s.st. | RAW: K01617-00 |
| c | K00701-00 | drip tray support rod, 65mm, M6F-M6F; s.st. | |
| d | K00173-00 | fender washer din9021 M6; s.st. | |
| e | K00178-00 | fender washer 6x18x2mm; natural nylon | |
| f | K00050-00 | bolt din933 M6x20; s.st. | |

* The drip tray is shown on the photo with the protective foil not removed yet.



Pump, portafilter, Idro-matic unit

For parts that can be found on other machine-models as well:

1. Pump, pump motors, water and discharge hoses:
www.keesvanderwesten.com/downloads/pumpsandhoses.pdf
2. Portafilters and filter baskets:
www.keesvanderwesten.com/downloads/portafilters.pdf
3. Idro-matic unit:
www.keesvanderwesten.com/assets/idro-matic-parts-list.pdf.

click the link above or copy-paste the address into your browser.

Body work

When in need of new panel work, contact us via support@keesvanderwesten.com to discuss the possibilities of replacement.

